

FD2002v2F

2MP Fixed Dome Camera

Quick Start Guide



Find additional manuals, the datasheet, the EU Declaration of Conformity, and the latest firmware for this product at:

tkhsecurity.com



Unpack

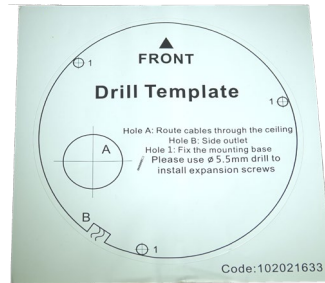

Duster

Subject to modification. Actual product and accessories may differ in appearance.

Installation Notices



Caution installation shall be performed by qualified personnel only. Installation shall be in accordance with local procedures. The camera contains batteries.

Battery replacement shall not be applied in view of the risk of explosion. Dispose of used batteries according to the instructions.

For "PoE" input connection, use only with UL listed I.T.E. with "PoE" output. Description for the "PoE" is intended to be connected to not exposed (outside plant) networks or equivalent statement in installation instructions.

Camera cabling

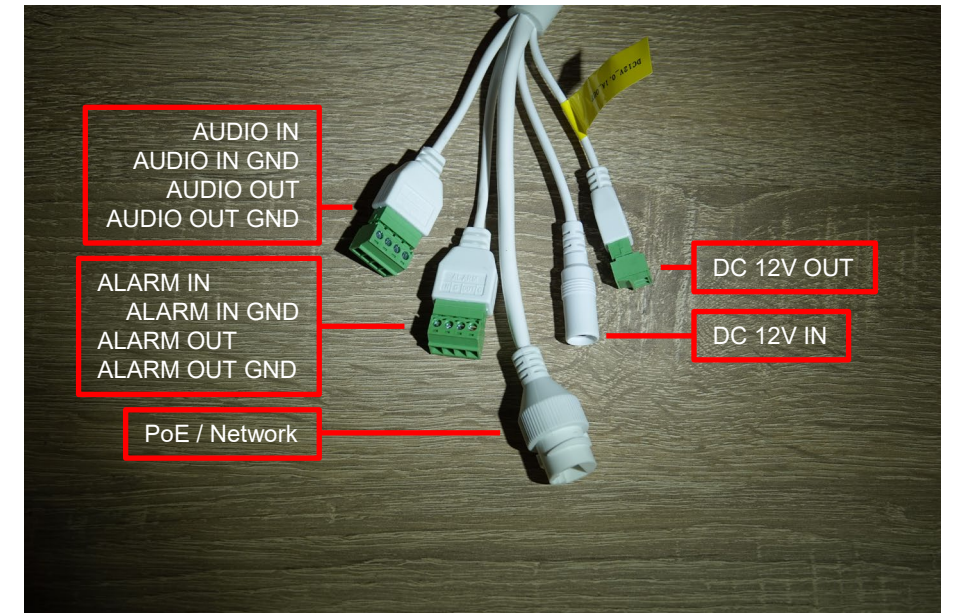

Pan / Tilt

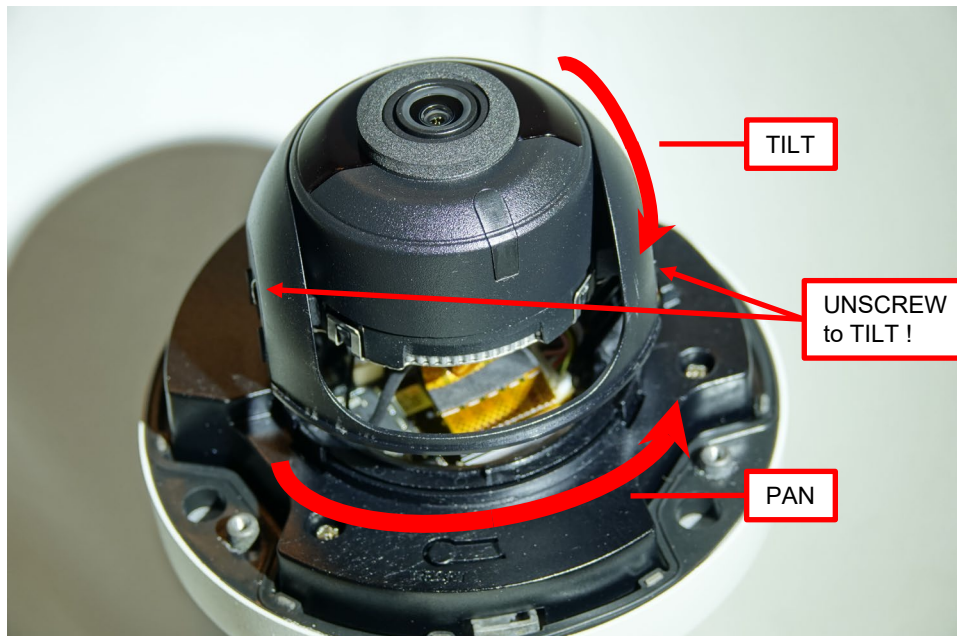

Reset button



To restore camera to factory defaults, power up with Reset button pressed for at least 10s.

SD card

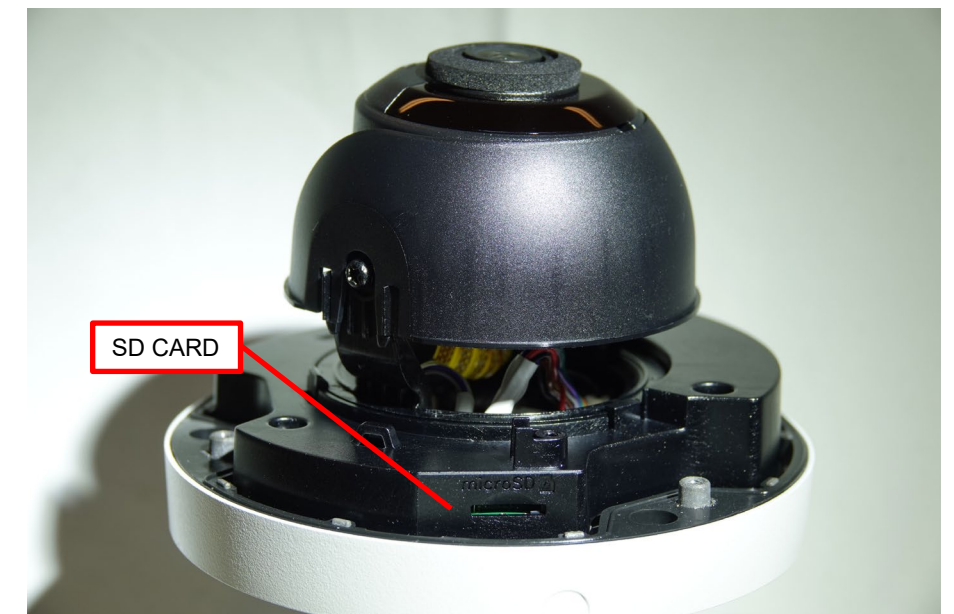

Accessing the Camera - DHCP

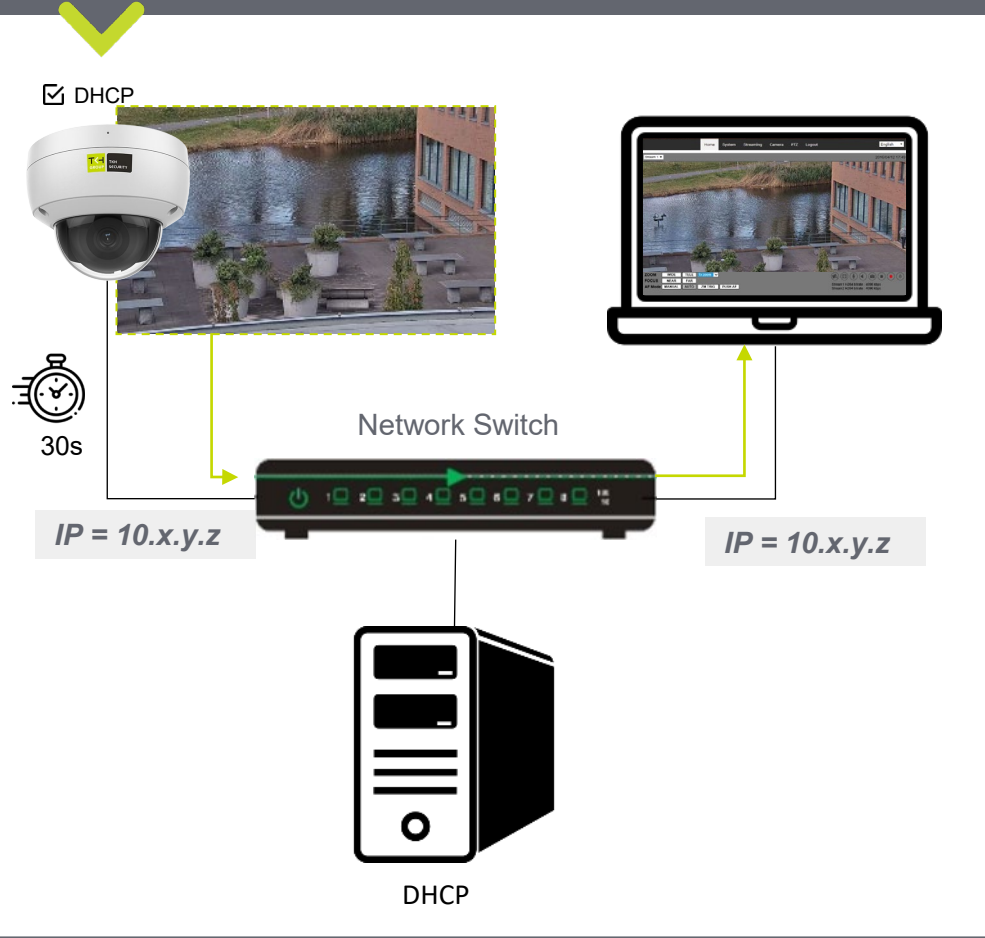

Accessing the camera – Fixed IP

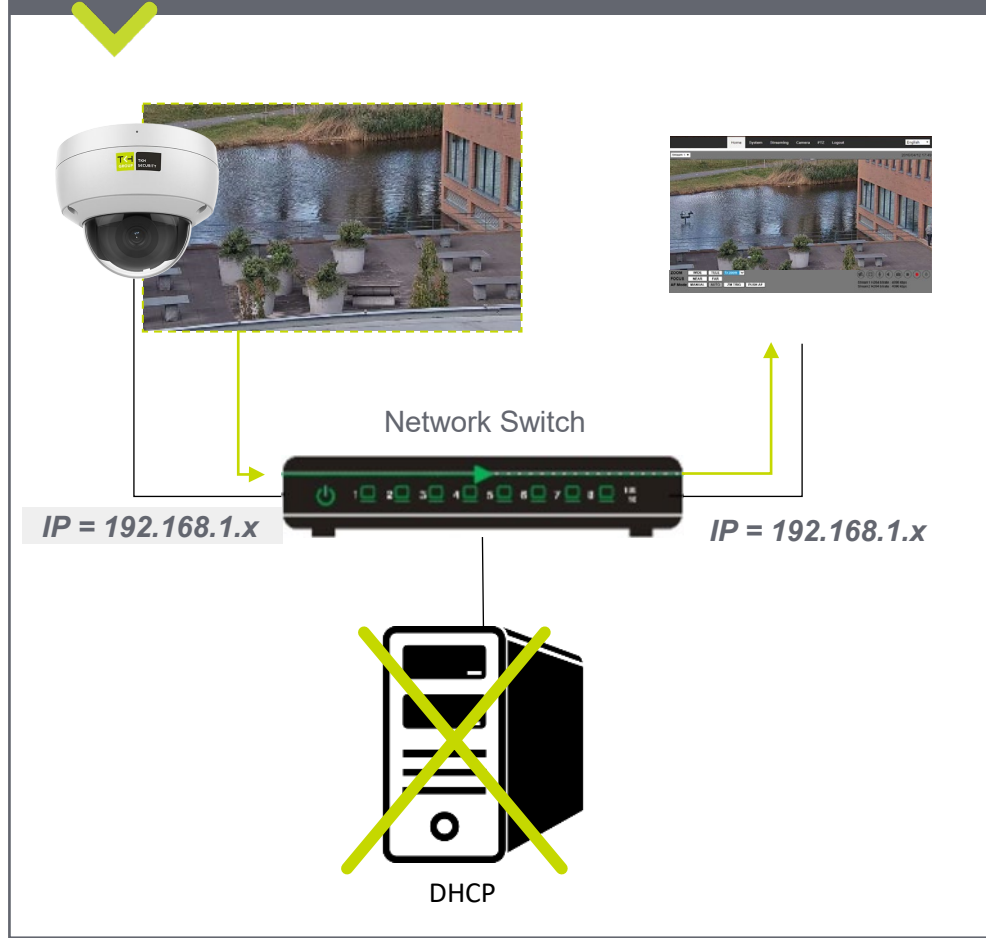

Auto detect with SDM2



1st time camera login

Set a strong password

Activation

User Name: admin

Password: [input field]

Valid password range [8-16]. You can use a combination of numbers, lowercase, uppercase and special character for your password with at least two kinds of them contained.

Confirm: [input field]

OK

qwer1234



x6W@oM0a!9#F



1st time camera login

SIQURA

User Name: [input field]

Password: [input field]

Language: English

Login

Forgot password?

Browser-based Viewer

SIQURA PD1022Z3-EI

admin Help Logout

- Live View
- Playback
- System
- Security
- Network
- Video/Audio
- Event
- PTZ
- Storage



It is not recommended to continuously (24/7) record with the micro SD card, as the card may not support long-term continuous data read/write. Contact the manufacturer of the micro SD card for information regarding the reliability and the life expectancy..